

D. REVIS.		BANDALUX	
REVISION	1 2 3 4 5 6 7 8 9		
DATE	11-10-2017	PLANE N°	
DESIGN	Miquel P.	FORMAT	A-4
SCALE	Rolling blind in Q-Style 85 motor cassette with decorative cover Ceiling installation Mechanism: motor 40 Bottom rail: round hembar 3/4" (Ø20mm) Tube 1 3/4" (Ø44mm)		
1/1			

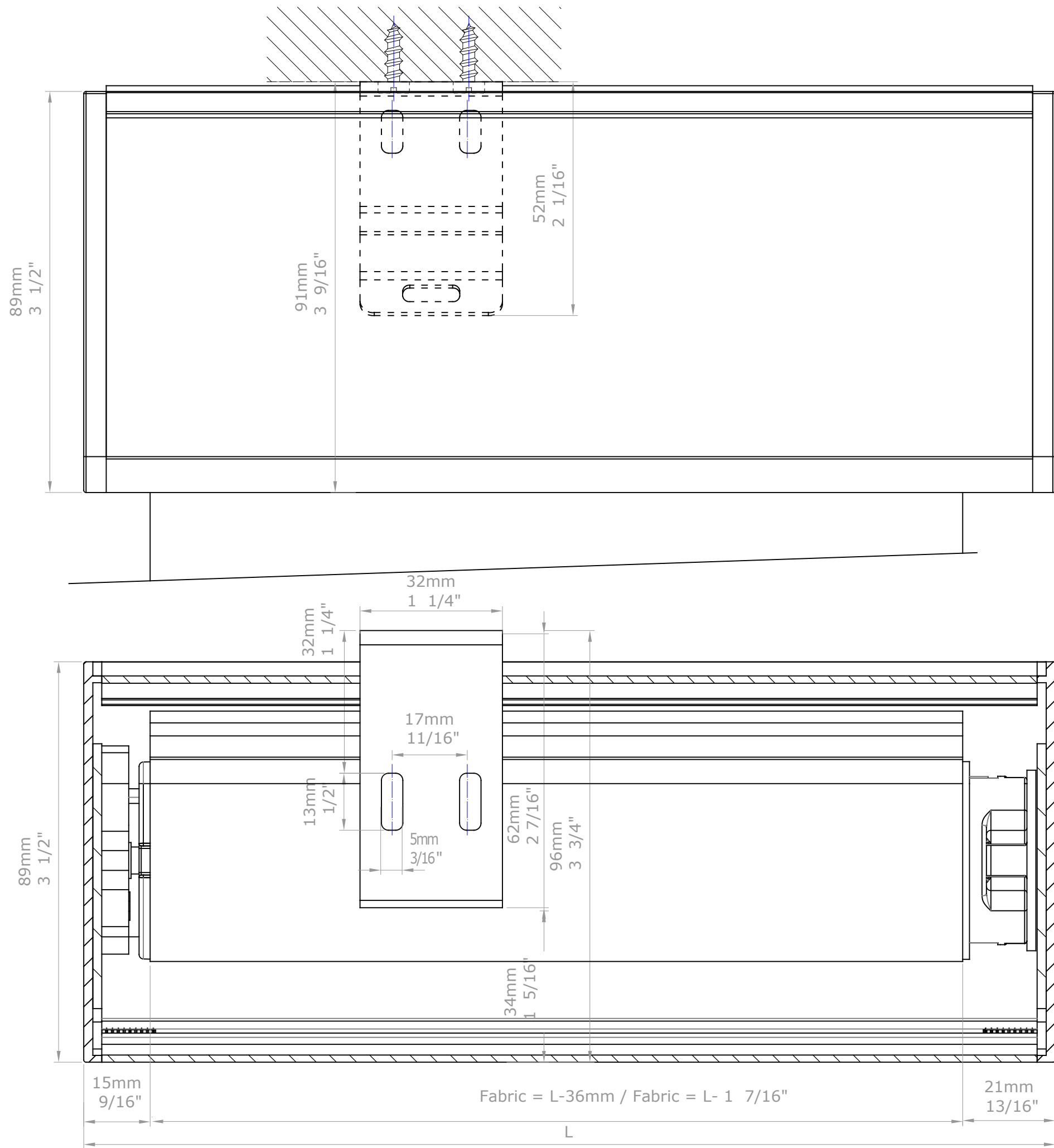

D. REVIS.		BANDALUX	
REVISION	123456789		
DATE	11-10-2017	PLANE N°	
DESIGN	Miquel P.	FORMAT	A-3
SCALE	Rolling blind in Q-Style 85 motor cassette with decorative cover Ceiling instalation Mechanism: motor 40 Bottom rail: round hembar 3/4" (Ø20mm) Tube 1 3/4" (Ø44mm)		
1/1			

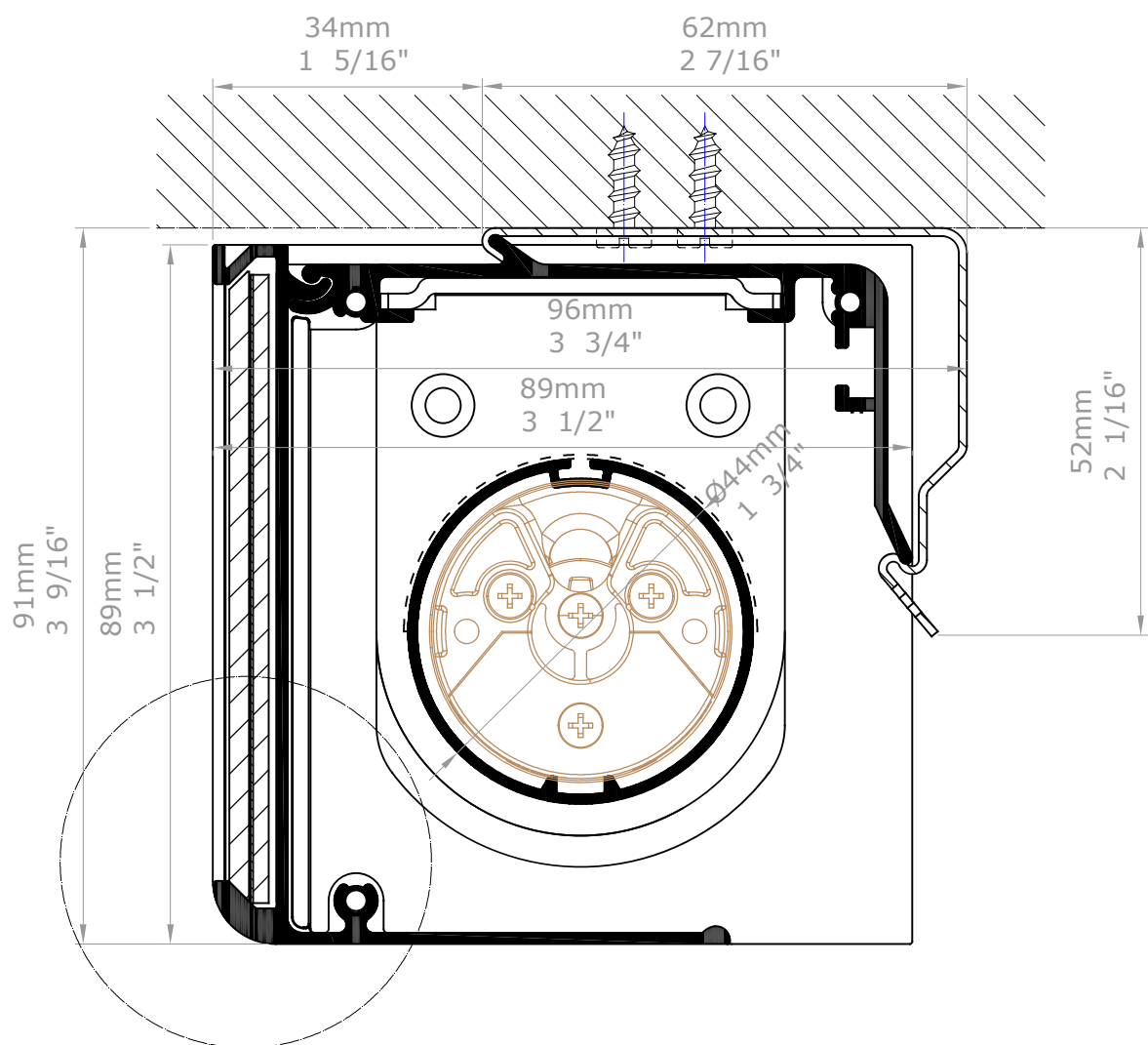

Option 1

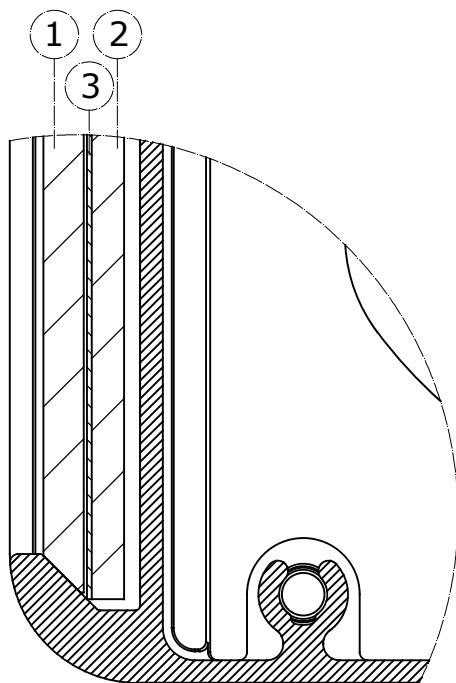

Option 2

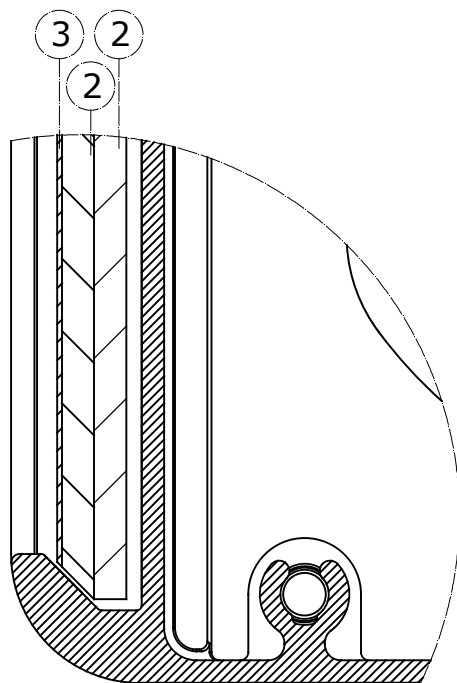

Option 3

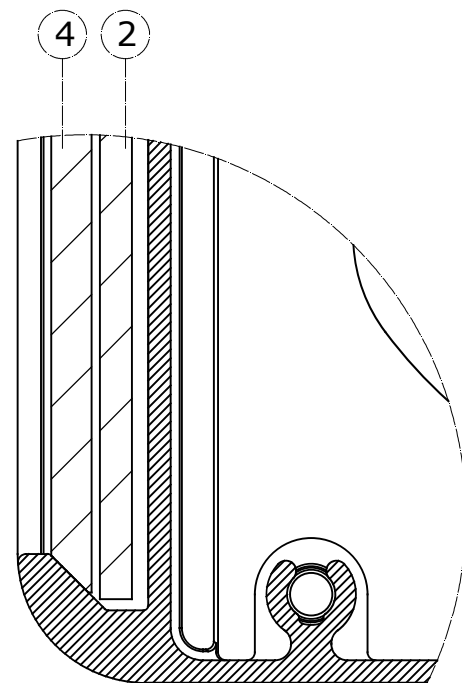

- 1: PMMA
2: PU
3: Decorative strip
4: PMMA opaque

E:2/1

D. REVIS.		BANDALUX	
REVISION	123456789		
DATE	11-10-2017	PLANE Nº	
DESIGN	Miquel P.	FORMAT	A-3
SCALE	Rolling blind in Q-Style 85 motor cassette with decorative cover Ceiling instalation Mechanism: motor 40 Bottom rail: round hembar 3/4" (Ø20mm) Tube 1 3/4" (Ø44mm)		
	1/1		

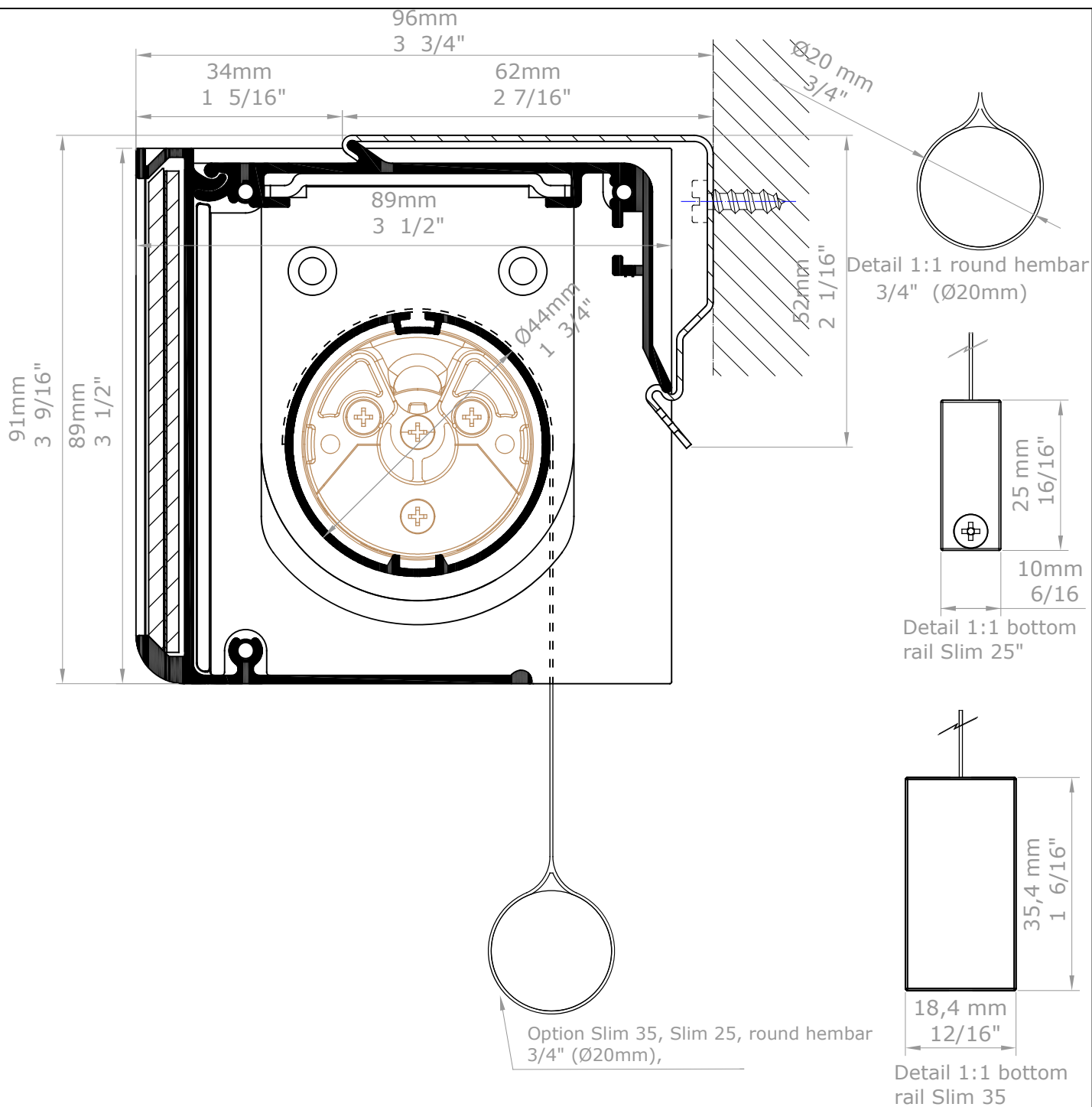

D. REVIS.		BANDALUX	
REVISION	1 2 3 4 5 6 7 8 9		
DATE	11-10-2017	PLANE N°	
DESIGN	Miquel P.	FORMAT	A-4
SCALE	Rolling blind in Q-Style 85 motor cassette with decorative cover Wall instalation Mechanism: motor 40 Bottom rail: round hembar 3/4" (Ø20mm) Tube 1 3/4" (Ø44mm)		
1/1			

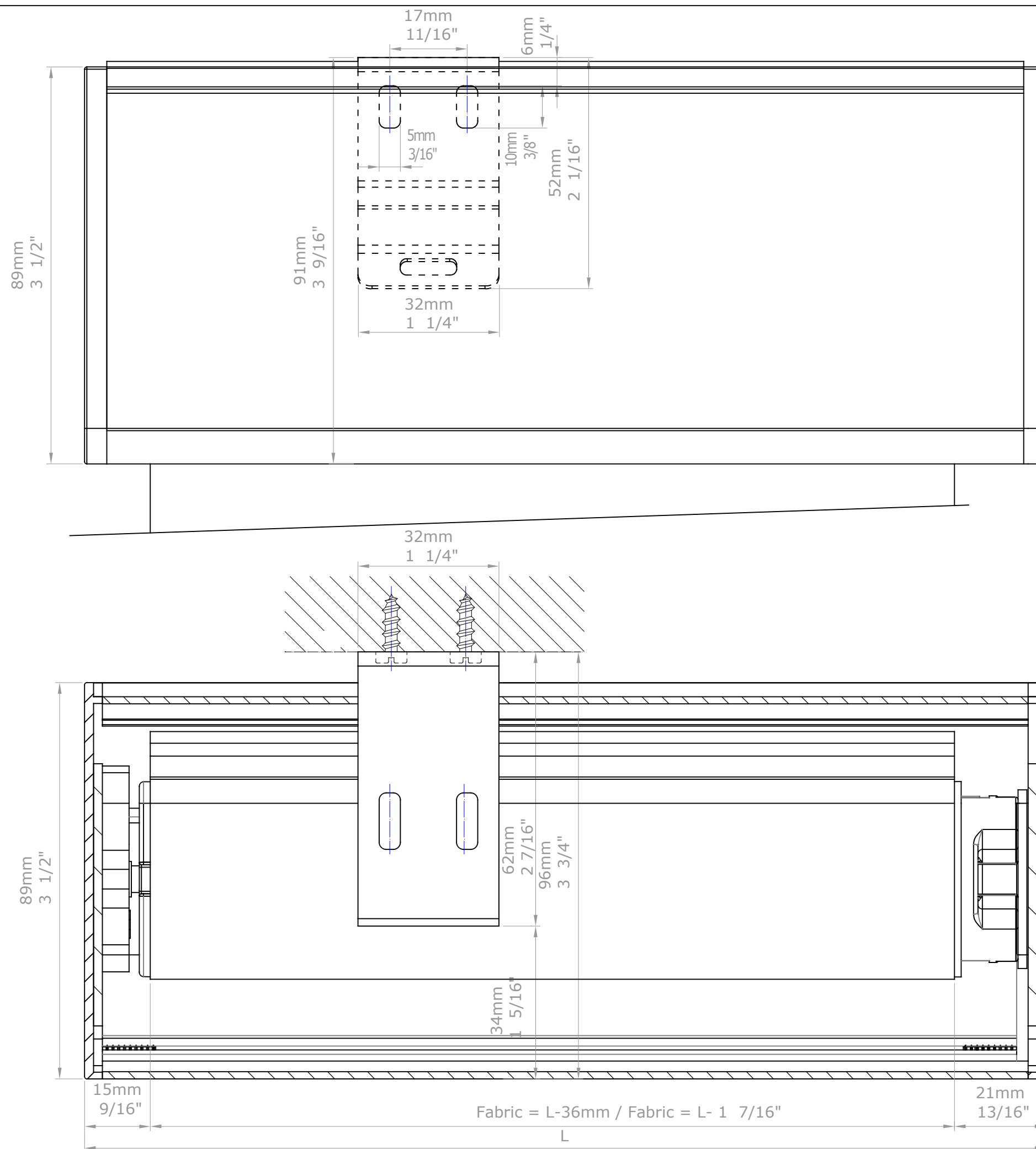

D. REVIS.		BANDALUX	
REVISION	123456789		
DATE	11-10-2017	PLANE N°	
DESIGN	Miquel P.	FORMAT	A-3
SCALE	Rolling blind in Q-Style 85 motor cassette with decorative cover Wall instalation Mechanism: motor 40 Bottom rail: round hembar 3/4" (Ø20mm) Tube 1 3/4" (Ø44mm)		
1/1			

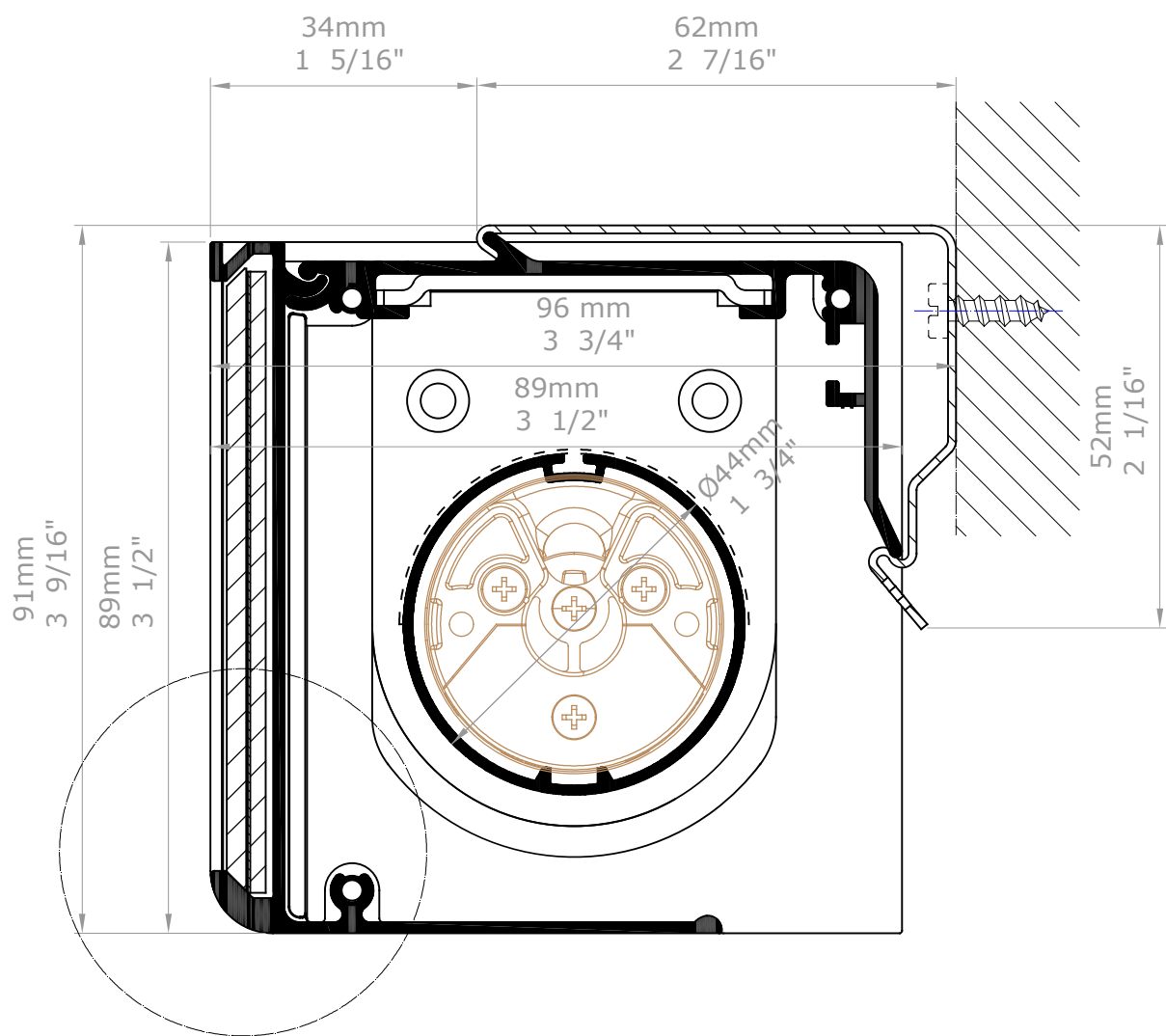

Option 1

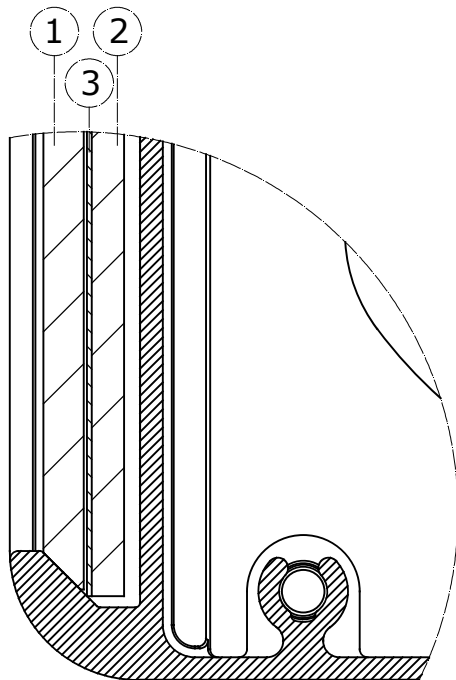

Option 2

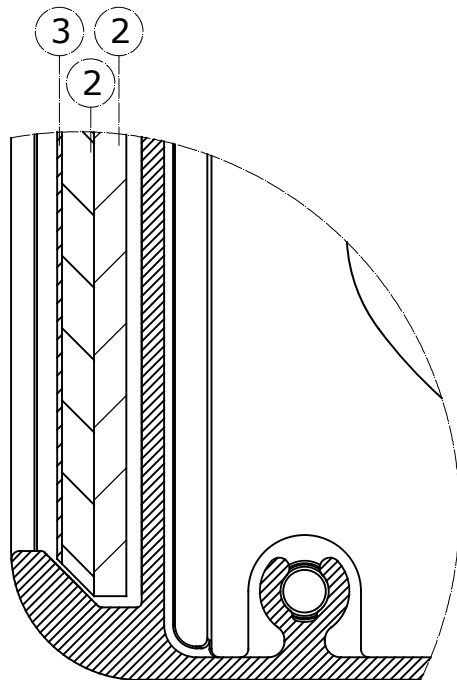

Option 3

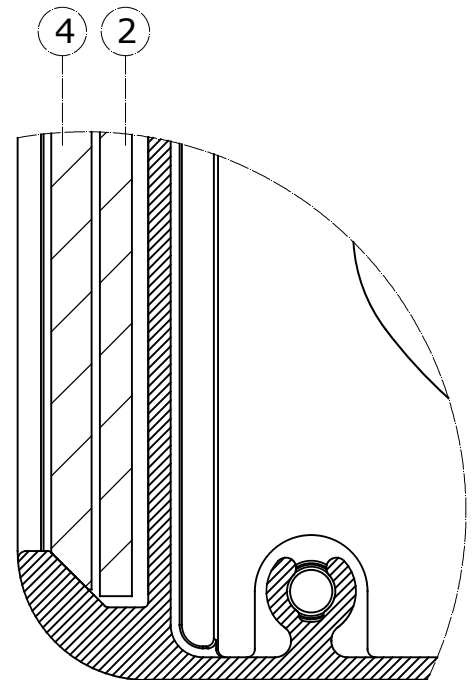

- 1: PMMA
2: PU
3: Decorative strip
4: PMMA opaque

E:2/1

D. REVIS.		BANDALUX	
REVISION	1 2 3 4 5 6 7 8 9		
DATE	11-10-2017	PLANE Nº	
DESIGN	Miquel P.	FORMAT	A-3
SCALE	Rolling blind in Q-Style 85 motor cassette with decorative cover Wall instalation Mechanism: motor 40 Bottom rail: round hembar 3/4" (Ø20mm) Tube 1 3/4" (Ø44mm)		
	1/1		

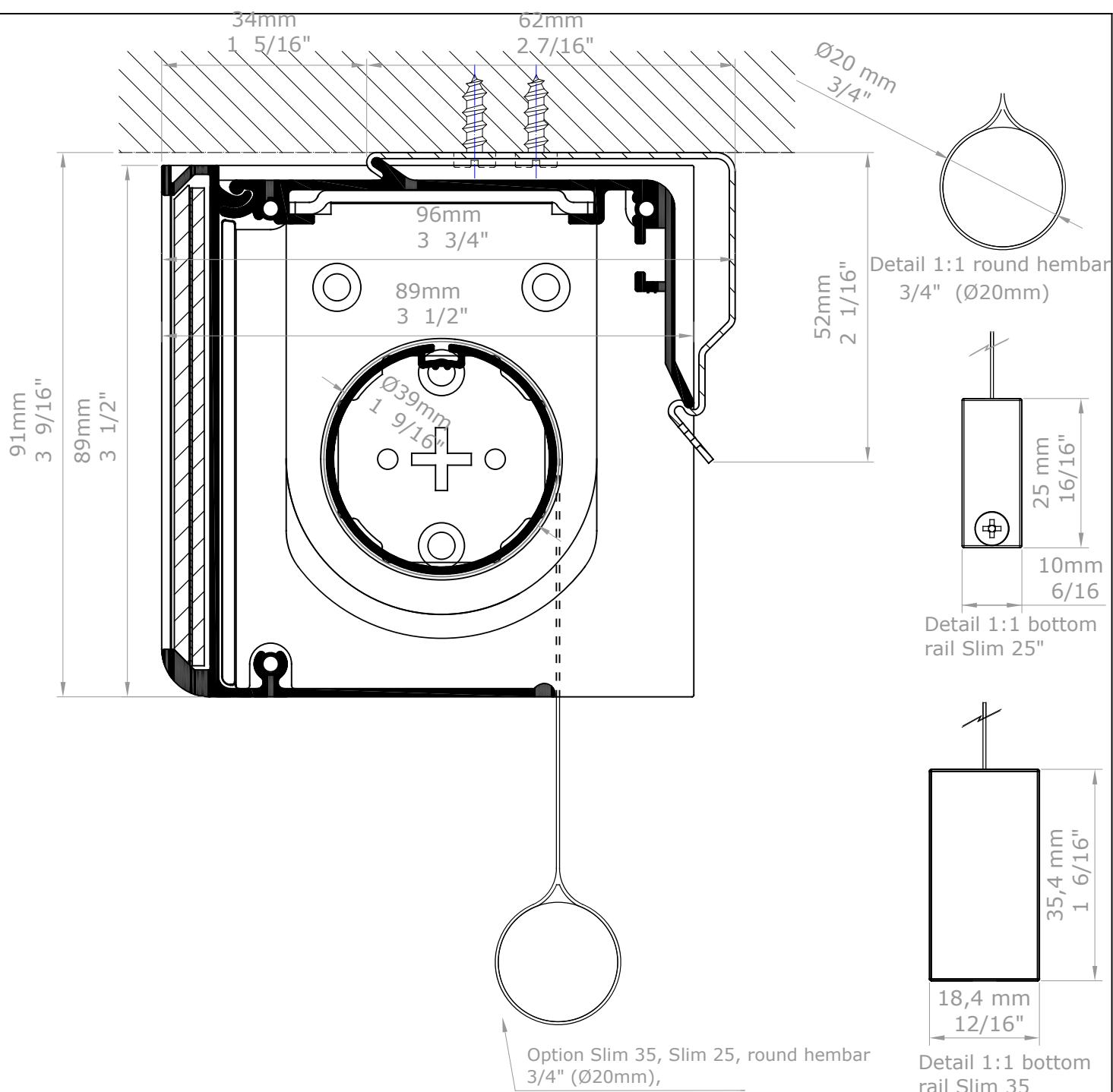

D. REVIS.		BANDALUX	
REVISION	1 2 3 4 5 6 7 8 9		
DATE	11-10-2017	PLANE N°	
DESIGN	Miquel P.	FORMAT	A-4
SCALE	Rolling blind in Q-Style 85 motor cassette with decorative cover Ceiling installation Mechanism: rechargeable battery motor Bottom rail: round hembar 3/4" (Ø20mm) Tube 1 1/2" (Ø38mm)		
1/1			

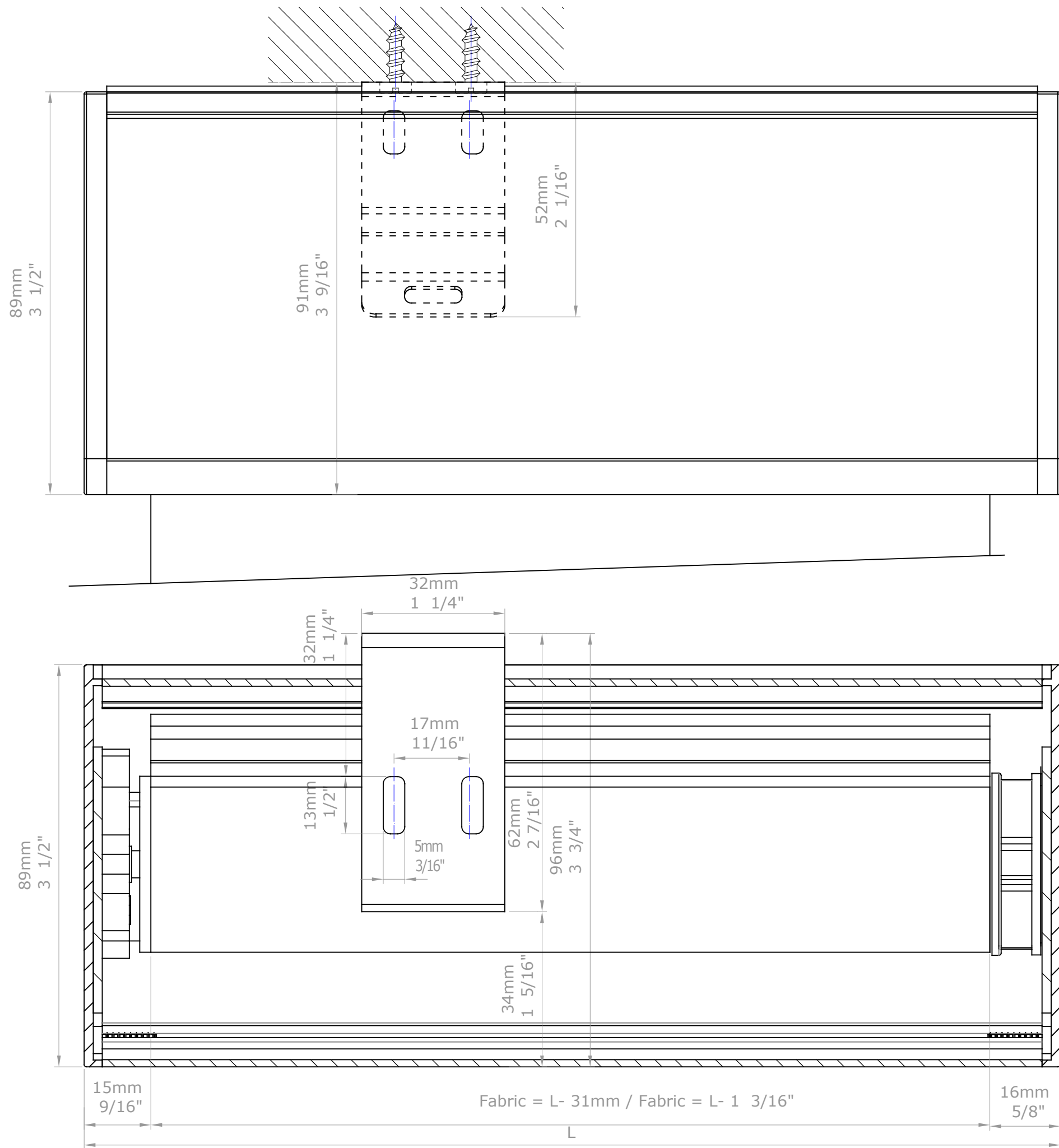

D. REVIS.		BANDALUX	
REVISION	123456789		
DATE	11-10-2017	PLANE N°	
DESIGN	Miquel P.	FORMAT	A-3
SCALE	Rolling blind in Q-Style 85 motor cassette with decorative cover Ceiling instalation Mechanism: rechargeable battery motor Bottom rail: round hembar 3/4" (Ø20mm) Tube 1 1/2" (Ø38mm)		
1/1			

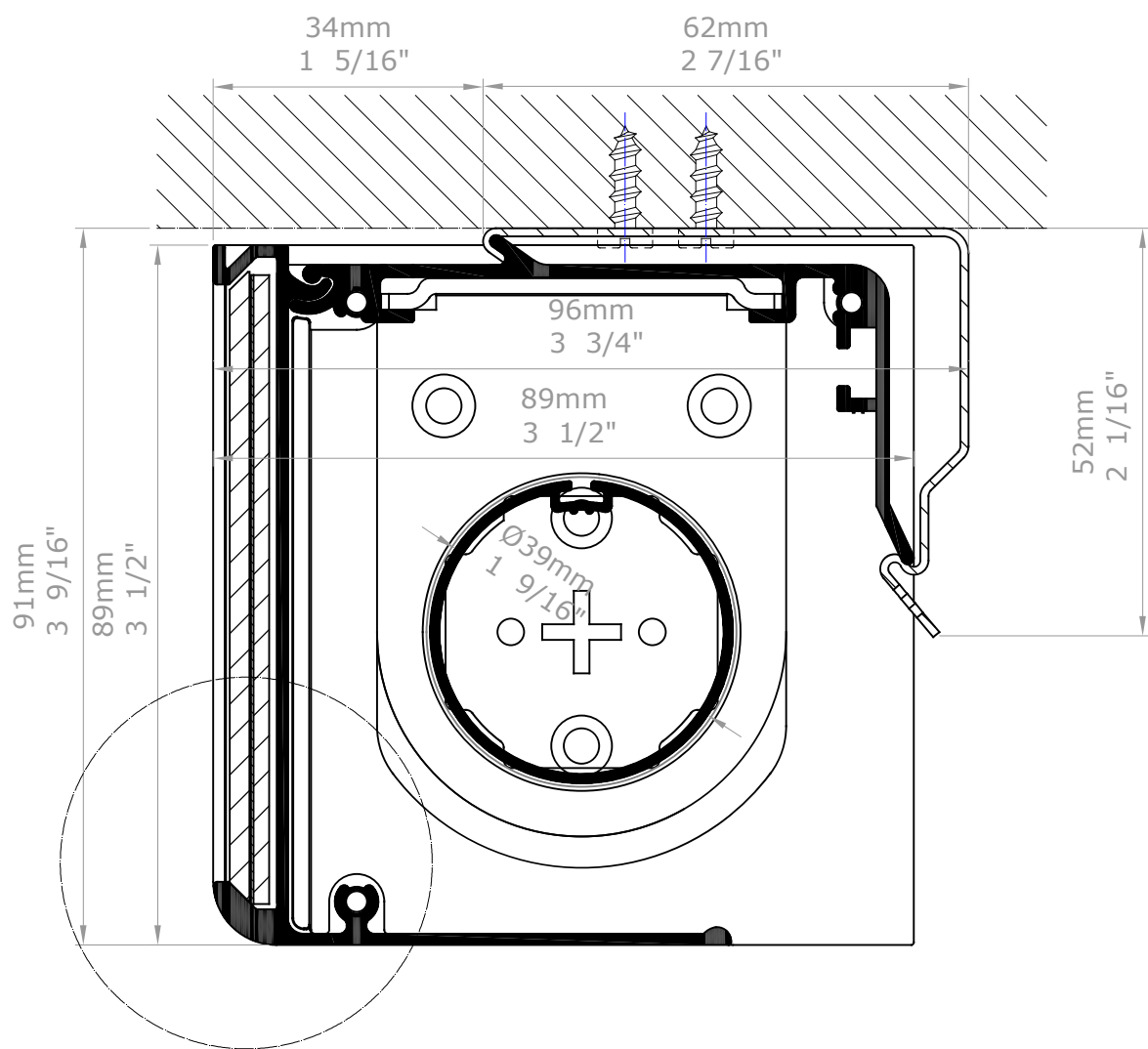

Option 1

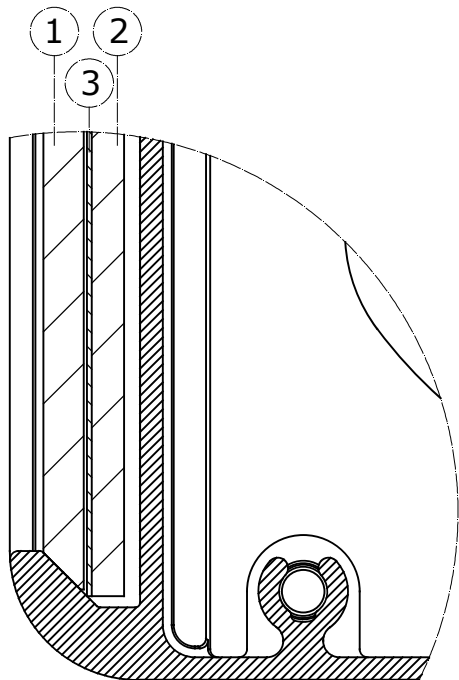

Option 2

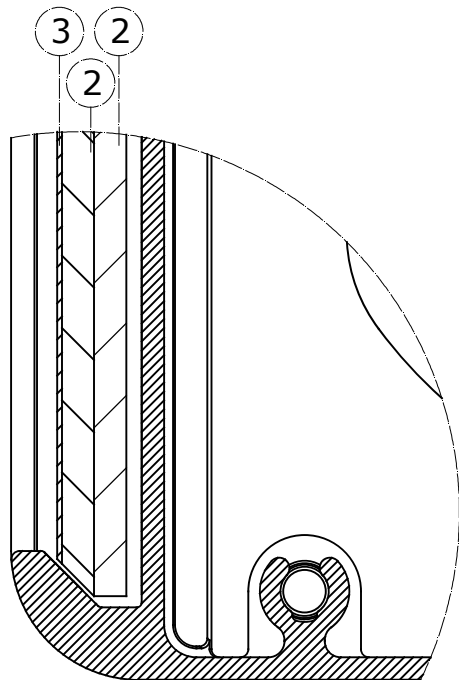

Option 3

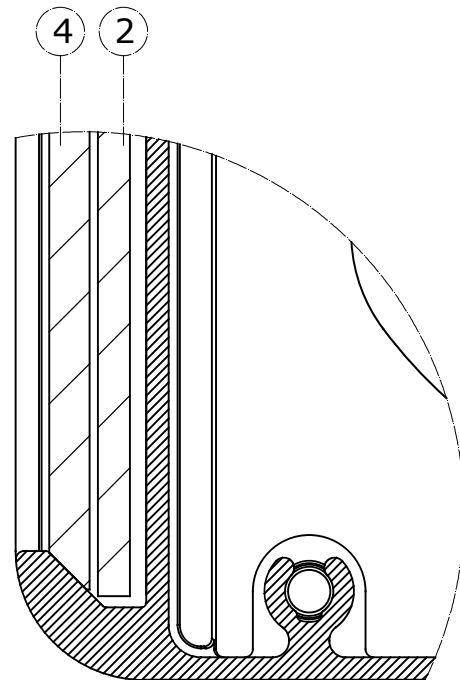

- 1: PMMA
2: PU
3: Decorative strip
4: PMMA opaque

E:2/1

D. REVIS.		BANDALUX	
REVISION	1 2 3 4 5 6 7 8 9		
DATE	11-10-2017	PLANE N°	
DESIGN	Miquel P.	FORMAT	A-3
SCALE	Rolling blind in Q-Style 85 motor cassette with decorative cover Ceiling instalation Mechanism: rechargeable battery motor Bottom rail: round hembar 3/4" (Ø20mm) Tube 1 1/2" (Ø38mm)		
	1/1		

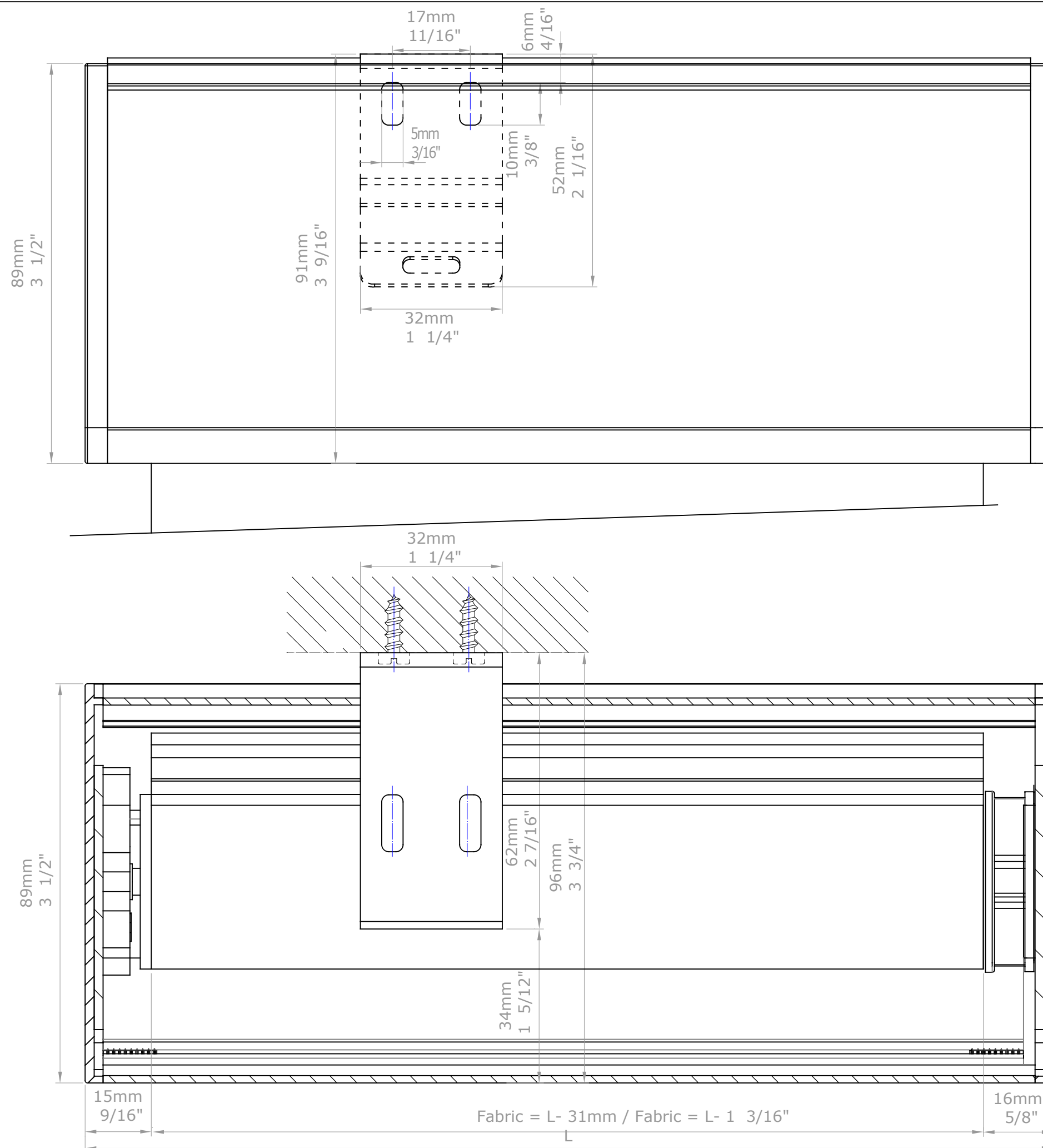

D. REVIS.		BANDALUX	
REVISION	123456789		
DATE	11-10-2017	PLANE N°	
DESIGN	Miquel P.	FORMAT	A-3
SCALE	Rolling blind in Q-Style 85 motor cassette with decorative cover Wall instalation Mechanism: rechargeable battery motor Bottom rail: round hembar 3/4" (Ø20mm) Tube 1 1/2" (Ø38mm)		
1/1			

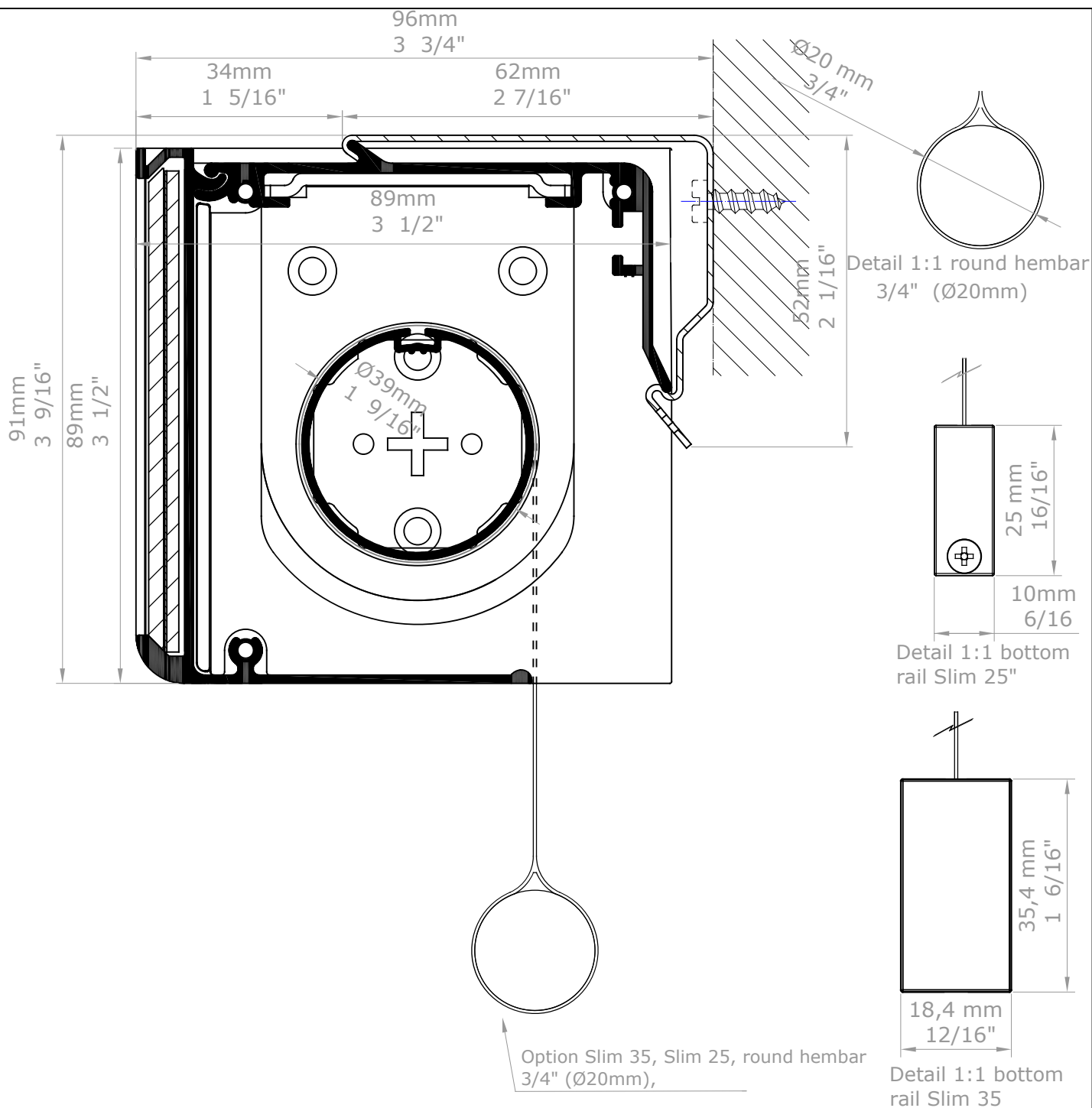

D. REVIS.		BANDALUX	
REVISION	1 2 3 4 5 6 7 8 9		
DATE	11-10-2017	PLANE N°	
DESIGN	Miquel P.	FORMAT	A-4
SCALE	Rolling blind in Q-Style 85 motor cassette with decorative cover Wall instalation Mechanism: rechargeable battery motor Bottom rail: round hembar 3/4" (Ø20mm) Tube 1 1/2" (Ø38mm)		
1/1			

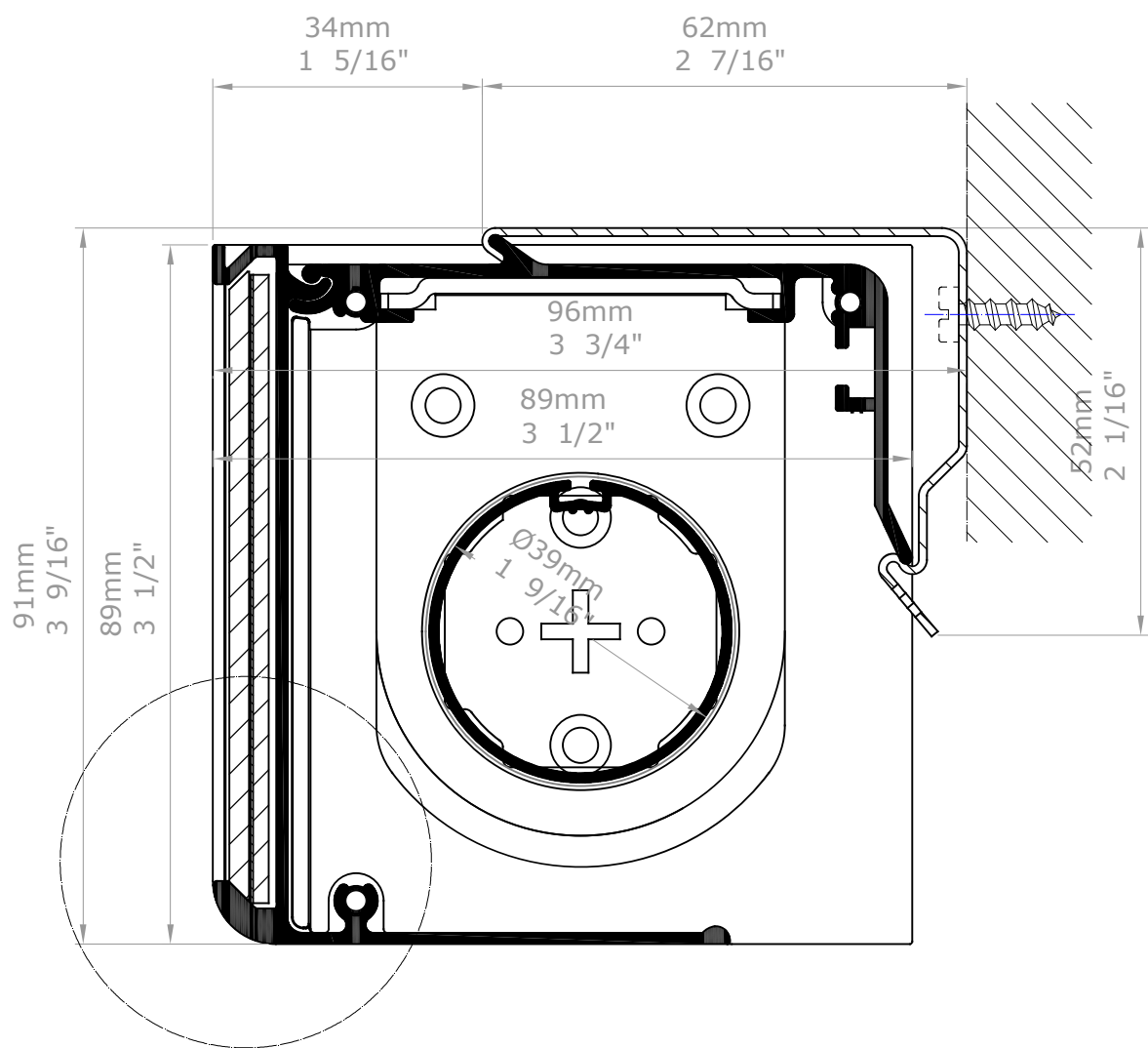

Option 1

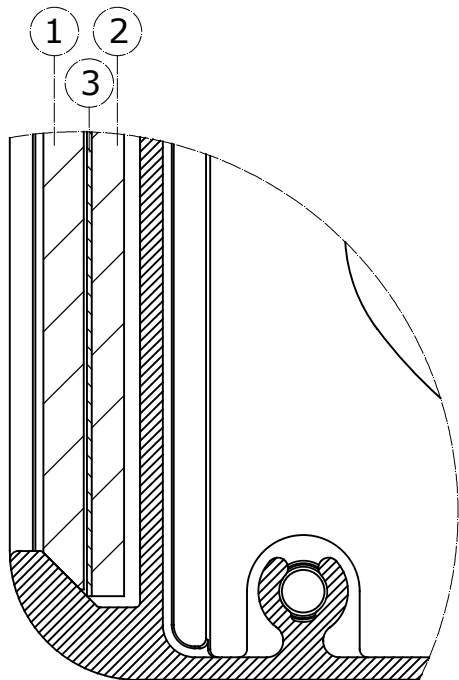

Option 2

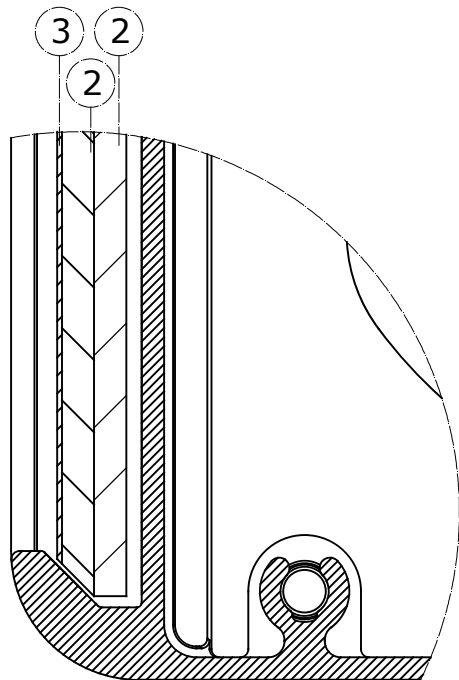

Option 3

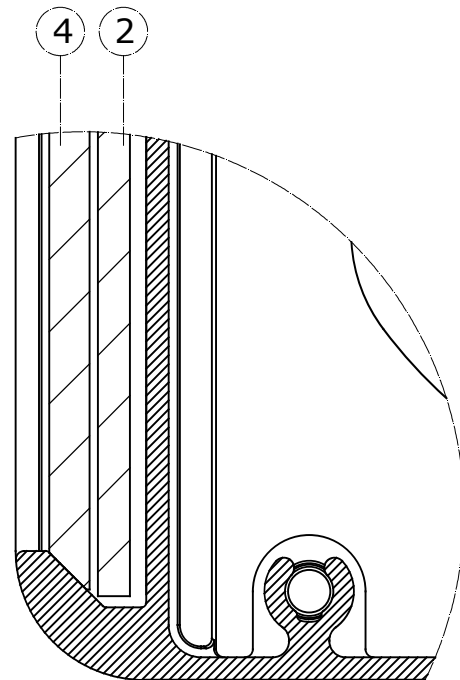

- 1: PMMA
2: PU
3: Decorative strip
4: PMMA opaque

E:2/1

D. REVIS.		BANDALUX	
REVISION	123456789		
DATE	11-10-2017	PLANE Nº	
DESIGN	Miquel P.	FORMAT	A-3
SCALE	Rolling blind in Q-Style 85 motor cassette with decorative cover Wall instalation Mechanism: rechargeable battery motor Bottom rail: round hembar 3/4" (Ø20mm) Tube 1 1/2" (Ø38mm)		
	1/1		